

HELI

CDD20J-Li Lithium-ion battery pallet stacker

Characteristics:

- AC drive; carbon-brush free and maintenance free.
- ZF transmission box has superior performance, high working and energy efficiency.
- The truck adopts side operation mode and has small turning radius and wide view.
- Imported waterproof inching switch is suitable for harsh application such as cold, humid and dust environment.
- LED electricity meter with four color is easy for reading.
- External placed charger has better cooling performance.
- Over length operation handle integrating lifting buttons, key switch and electricity meter satisfy ergonomic requirements and make operation easier; low speed switch makes speed control more accurate; good air pressure type can reset automatically and slowly and it is durable.
- High-density protection guard is solid and durable.



CDD20J-Li

Manufacturer's Data and Design Characteristics

Characteristics							
1.01	Manufacturer	HELI					
1.02	Model	CDD20J-Li					
1.03	Operator	Pedestrian propelled					
1.04	Rated traction weight	Q (kg)	2000				
1.05	Mast type		Single mast	2-Stage STD			
1.06	Lift	h3 (mm)	1600	2000	2500	3000	3500
1.07	Capacity at highest height	kg	2000	2000	2000	1600	1250
1.08	Service weight(include battery)	kg	760	872	862	890	868
1.09	Load centre	c (mm)	600				
1.10	Axle centre to fork face	x (mm)	672				
1.11	Wheel base	y (mm)	1384				
1.12	Controller		CURTIS				
Wheel/Tyres							
2.01	Wheel type	Φ × w (mm)	Polyurethane				
2.02	Driving wheel size	Φ × w (mm)	Φ230 × 75				
2.03	Bearing wheel size	Φ × w (mm)	Φ60 × 70				
2.04	Additional wheels (dimensions)	Φ × w (mm)	Φ150 × 58				
2.05	Wheels, number front/rear (x=driver)		1x=1/4				
Dimensions							
3.01	Height of mast, lowered	h1 (mm)	1990	1491	1741	1991	2241
3.02	Height of mast, extended	h4 (mm)	1990	2408	2908	3408	3908
3.03	Fork Height, Lowered	h13 (mm)	86				
3.04	Overall length	l1 (mm)	2022				
3.05	Length to fork face	l2 (mm)	872				
3.06	Overall width	b1/ b2 (mm)	795				
3.07	Fork dimensions	s,e/l (mm)	60/180/1150				
3.08	Width of forks	b5 (mm)	570/650/695				
3.09	Min. Ground clearance	m2 (mm)	26				
3.10	Alise width with pallet 1000 x 1200 across forks	ast (mm)	2435				
3.11	Alise width with pallet 800 x 1200 along forks	ast (mm)	2412				
3.12	Min. Turning radius	Wa (mm)	1550				
Performance							
4.01	Travel speed, with/without load	(km/h)	4.0/4.2				
4.02	Lifting speed, with/without load	(mm/s)	80/210				
4.03	Lowering speed, with/without load	(mm/s)	152/160				
4.04	Max. gradeability laden/unladen	(%)	4/10				
4.05	Service brake type		Electromagnetic brake				
Drive							
5.01	Drive motor, output S2 60 min.	(kW)	1.5 (AC)				
5.02	Lift motor rating at S3 15%	(kW)	3				
5.03	Battery according to DIN 41331/35/36 A,B,C, no		no				
5.04	Battery voltage/rated capacity	(V/Ah)	24/150 (LFP)				
5.05	Battery weight (± 5%)	(kg)	58				
Others							
6.01	Sound pressure level at driver's ear	(dB(A))	≤ 70				
6.02	Steering type		Mechanical steering				

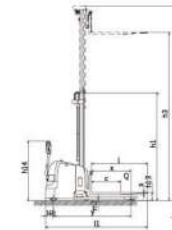
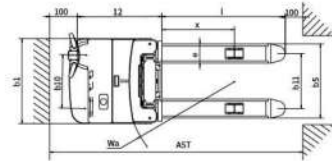

ANHUI HELI CO., LTD.
Add / No.668, FangXing Road, Hefei, China
Fax / +86-551-63639966

Tel / +86-551-63639068(America); 63639258(Europe);
63639358(Asia); 63662105(Africa & Middle East);
63639530(Key Accounts Division); 63662105(Wheel loader)

* Our products are subject to improvements and changes without notice.

CDD12J-Li/CDD12JD-Li Lithium-ion battery pallet stacker

Characteristics:

- High power lift pump has high working efficiency.
- Side driving design achieves a smaller steering radius and wide view.
- The driving system with permanent magnetic motor has small volume, light weight and low consumption.
- German water-proof inching switch meets the requirements of harsh working condition such as cold, humidity and dust circumstances.
- Four colors LED electricity meter makes it simple and easy to read.
- External charger has better cooling performance.
- It's more comfortable and easier for operator using a super long handle that integrates with lifting button, key switch, electricity meter, which is suitable for ergonomics; more accurate speed control with turtle speed switch; more durable with high quality air-pressure springs which allows slowly and automatically reset.
- Iron steel protection guard with high density, which is more durable, firm and has high protection effect.
- Maintenance-free battery.



CDD12J-Li/CDD12JD-Li

Manufacturer's Data and Design Characteristics								
Characteristics								
1.01	Manufacturer		HELI					
1.02	Model		CDD12J-Li					CDD12JD-Li
1.03	Operation		Pedestrian propelled					
1.04	Rated traction weight	Q (kg)	1200					
1.05	Mast type		Single mast	2-Stage STD				Mono mast
1.06	Lift	h3 (mm)	1600	2000	2500	3000	3500	1600
1.07	Capacity at highest height	kg	1200	1050	900	750	600	1200
1.08	Service weight(include battery)	kg	358	404	418	450	472	368
1.09	Load centre	c (mm)	600					
1.10	Axle centre to fork face	x (mm)	780					
1.11	Wheel base	y (mm)	1230					1100
1.12	Controller		CURTIS					
Wheels/Tyres								
2.01	Wheels type	Φ×w(mm)	Polyurethane					
2.02	Driving wheel size	Φ×w(mm)	Φ210×70					
2.03	Bearing wheel size	Φ×w(mm)	Φ80×70					
2.04	Additional wheels (dimensions)		Φ150×58					
2.05	Wheels, number front/rear (x = driven)		1x+1/4					
Dimensions								
3.01	Height of mast, lowered	h1 (mm)	2014	1495	1745	1995	2245	1990
3.02	Height of mast, extended	h4 (mm)	2014	2452	2952	3452	3952	2060
3.03	Fork Height, Lowered	h13 (mm)	86					
3.04	Overall length	l1 (mm)	1755					1632
3.05	Length to fork face	l2 (mm)	605					482
3.06	Overall width	b1/ b2 (mm)	795					
3.07	Fork dimensions	s/e/l (mm)	60/160/1150					
3.08	Width of forks	b5 (mm)	570/650/695					
3.09	Min.Ground clearance	m2 (mm)	26					
3.10	Aisle width with pallet 1000 x 1200 across forks	Ast (mm)	2245					2120
3.11	Aisle width with pallet 800 x 1200 along forks	Ast (mm)	2185					2060
3.12	Min.Turning radius	Wa (mm)	1405					1280
Performance								
4.01	Travel speed, with/without load	(km/h)	4.0/4.2					
4.02	Lifting speed, with/without load	(mm/s)	92/136					
4.03	Lowering speed, with/without load	(mm/s)	112/98					
4.04	Max. gradeability laden/unladen	(%)	3/10					
4.05	Service brake		Electromagnetic brake					
Drive								
5.01	Drive motor, output S2 60 min.	(kW)	0.75					
5.02	Lift motor rating at S3 15%	(kW)	2.2					
5.03	Battery according to DIN 43531/35/36 A,B,C,no		no					
5.04	Battery voltage/rated capacity	(V/Ah)	24/60 (LFP)					
5.05	Battery weight (± 5%)	(kg)	16					
Others								
6.01	Noise level at operator's ears	(dB(A))	≤70					
6.02	Steering type		Mechanical steering					

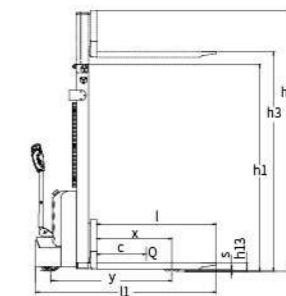
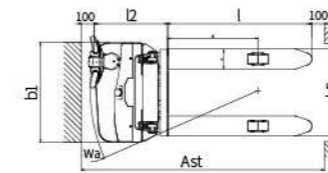

ANHUI HELI CO., LTD.

Add / No.668, FangXing Road, Hefei, China
Fax / +86-551-63639966

Tel / +86-551-63639068(America); 63639258(Europe);
63639358(Asia); 63662105(Africa & Middle East);
63639530(Key Accounts Division); 63662105(Wheel loader)

CDD15J-Li

Lithium-ion battery pallet stacker



Characteristics:

- High power lift pump has high working efficiency.
- Side driving design achieves a smaller steering radius and wide view.
- The driving system with permanent magnetic motor has small volume, light weight and low consumption.
- German water-proof inching switch meets the requirements of harsh working condition such as cold, humidity and dust circumstances.
- Four colors LED electricity meter makes it simple and easy to read.
- External charger has better cooling performance. It's more comfortable and easier for operator using a super long handle that integrates with lifting button, key switch, electricity meter, which is suitable for ergonomics; more accurate speed control with turtle speed switch; more durable with high quality air-pressure springs which allows slowly and automatically reset.
- Iron steel protection guard with high density, which is more durable, firm and has high protection effect.
- Maintenance-free battery.

CDD15J-Li

Manufacturer's Data and Design Characteristics

Characteristics							
1.01	Manufacturer	HELI					
1.02	Model	CDD15J-Li					
1.03	Operation	Pedestrian propelled					
1.04	Rated traction weight	Q (kg)	1500				
1.05	Mast type		Single mast	2-Stage STD			
1.06	Lift	h3 (mm)	1600	2000	2500	3000	3500
1.07	Capacity at highest height	kg	1500	1300	1100	900	750
1.08	Service weight (include battery)	kg	374	422	436	466	488
1.09	Load centre	c (mm)	600				
1.10	Axle centre to fork face	x (mm)	780				
1.11	Wheel base	y (mm)	1225				
1.12	Controller		CURTIS				
Wheels							
2.01	Wheels type		Polyurethane				
2.02	Driving wheel size	Φ×w(mm)	Φ210×70				
2.03	Bearing wheel size	Φ×w(mm)	Φ80×70				
2.04	Additional wheels (dimensions)	Φ×w(mm)	Φ115×55				
2.05	Wheels, number front/rear (x = driven)		1x+1/4				
Dimensions							
3.01	Height of mast, lowered	h1 (mm)	2014	1495	1745	1995	2245
3.02	Height of mast, extended	h4 (mm)	2014	2452	2952	3452	3952
3.03	Fork Height, Lowered	h13 (mm)	86				
3.04	Overall length	l1 (mm)	1740				
3.05	Length to fork face	l2 (mm)	590				
3.06	Overall width	b1/ b2 (mm)	795				
3.07	Fork dimensions	s/e/l (mm)	60/160/1150				
3.08	Width of forks	b5 (mm)	570/650/695				
3.09	Min.Ground clearance	m2 (mm)	26				
3.10	Aisle width with pallet1000 x 1200 across forks	Ast (mm)	2245				
3.11	Aisle width with pallet800 x 1200 along forks	Ast (mm)	2185				
3.12	Min.Turning radius	Wa (mm)	1405				
Performance							
4.01	Travel speeds, with/without load	(km/h)	4.0/4.2				
4.02	Lifting speed, with/without load	(mm/s)	92/136				
4.03	Lowering speed, with/without load	(mm/s)	112/98				
4.04	Max. gradeability laden/unladen	(%)	3/10				
4.05	Service brake		Electromagnetic brake				
Drive and Battery							
5.01	Drive motor, output S2 60 min.	(kW)	0.75				
5.02	Lift motor rating at S3 15%	(kW)	2.2				
5.03	Battery according to DIN43531/35/36 A,B,C,no		no				
5.04	Battery voltage/rated capacity	(V/Ah)	24/60 (LFP)				
5.05	Battery weight (± 5%)	(kg)	16				
Others							
6.01	Noise level at operator's ears	(dB(A))	≤70				
6.02	Steering type		Mechanical steering				

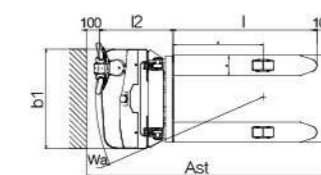
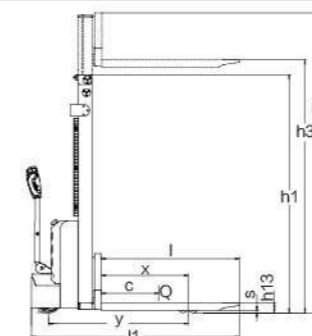

ANHUI HELI CO., LTD.

Add / No.668, FangXing Road, Hefei, China
Fax / +86-551-63639966

Tel / +86-551-63639068(America); 63639258(Europe);
63639358(Asia); 63662105(Africa & Middle East);
63639530(Key Accounts Division); 63662105(Wheel loader)

CDD16J-Li Lithium-ion battery pallet stacker

Characteristics:

- AC drive; carbon-brush free and maintenance free.
- ZF transmission box has superior performance, high working and energy efficiency.
- The truck adopts side operation mode and has small turning radius and wide view.
- Imported waterproof inching switch is suitable for harsh application such as cold, humid and dust environment.
- LED electricity meter with four color is easy for reading.
- External placed charger has better cooling performance.
- Over length operation handle integrating lifting buttons, key switch and electricity meter satisfy ergonomic requirements and make operation easier; low speed switch makes speed control more accurate; good air pressure type can reset automatically and slowly and it is durable.
- High-density protection guard is solid and durable.



CDD16J-Li

Manufacturer's Data and Design Characteristics

Characteristics							
1.01	Manufacturer	HELI					
1.02	Model	CDD16J-Li					
1.03	Operation	Pedestrian propelled					
1.04	Rated traction weight	Q (kg)	1600				
1.05	Mast type	Singlemast	2-Stage STD				
1.06	Lift	h3 (mm)	1600	2000	2500	3000	3500
1.07	Capacity at highest height	kg	1600	1600	1600	1350	1100
1.08	Service weight(include battery)	kg	522	586	610	634	658
1.09	Load centre	c (mm)	600				
1.10	Axle centre to fork face	x (mm)	675				
1.11	Wheel base	y (mm)	1118				
1.12	Controller	CURTIS					
Wheels		Polyurethane					
2.01	Wheel type	Polyurethane					
2.02	Driving wheel size	Φ × w (mm)	Φ230 × 75				
2.03	Bearing wheel size	Φ × w (mm)	Φ80 × 70				
2.04	Additional wheels (dimensions)	Φ × w (mm)	Φ150 × 58				
2.05	Wheels, number front/rear (x = driven)	1x+1/4					
Dimensions							
3.01	Height of mast, lowered	h1 (mm)	2014	1495	1745	1995	2245
3.02	Height of mast, extended	h4 (mm)	2014	2452	2952	3452	3952
3.03	Fork Height, Lowered	h13 (mm)	86				
3.04	Overall length	l1 (mm)	1755				
3.05	Length to fork face	l2 (mm)	605				
3.06	Overall width	b1/ b2 (mm)	795				
3.07	Fork dimensions	s/e/l (mm)	60/180/1150				
3.08	Width of forks	b5 (mm)	570/650/695				
3.09	Min. Ground clearance	m2 (mm)	26				
3.10	Aisle width with pallet 1000 x 1200 across forks	Ast (mm)	2178				
3.11	Aisle width with pallet 800 x 1200 along forks	Ast (mm)	2156				
3.12	Min. Turning radius	Wa (mm)	1295				
Performance							
4.01	Travel speed, with/without load	(km/h)	4.0/4.2				
4.02	Lifting speed, with/without load	(mm/s)	92/136				
4.03	Lowering speed, with/without load	(mm/s)	112/98				
4.04	Max. gradeability laden/unladen	(%)	6/10				
4.05	Service brake type	Electromagnetic brake					
Drive							
5.01	Drive motor, output S2 60 min.	(kW)	1.5 (AC)				
5.02	Lift motor rating at S3 15%	(kW)	2.2				
5.03	Battery according to DIN 43531/35/36 A, B, C, no		no				
5.04	Battery voltage/rated capacity	(V/Ah)	24V/60 (LFP)				
5.05	Battery weight (± 5%)	(kg)	16				
Others							
6.01	Sound pressure level at driver's ear	(dB(A))	≤ 70				
6.02	Steering type	Mechanical steering					

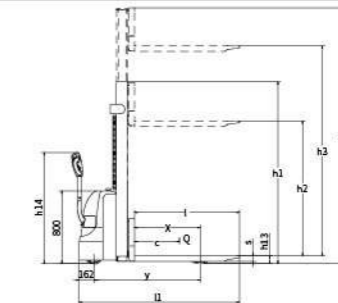
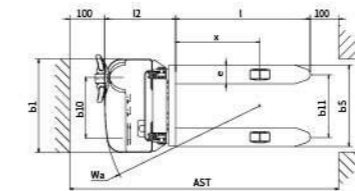

ANHUI HELI CO., LTD.
Add / No.668, FangXing Road, Hefei, China
Fax / +86-551-63639966

Tel / +86-551-63639068(America); 63639258(Europe);
63639358(Asia); 63662105(Africa & Middle East);
63639530(Key Accounts Division); 63662105(Wheel loader)